

Deluxe Series - Model: 203321M Plus

Radius Corners

Rear positioned drain holes to maximize usable bowl and cabinet storage space below

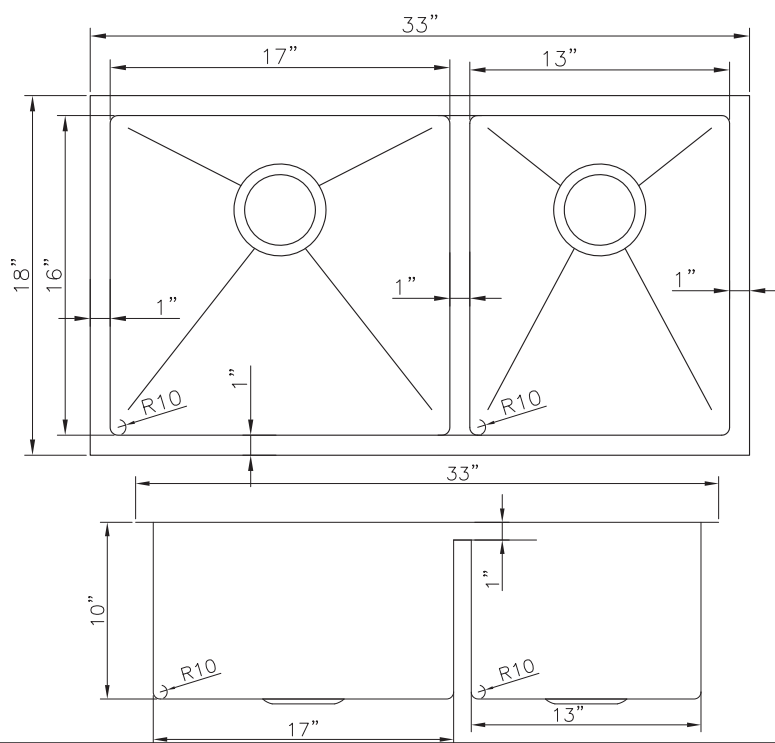

Specifications:

- Handcrafted
- 316 Stainless Steel 16 Gauge
- 18/10 Chrome Nickel Content
- Bowl Corner Radius of 10mm
- Undermount clips
- Template
- Stainless Steel Strainers
- 9" Deep
- 1" Wide Central Lowered 1"

Outside: 33" x 18" x 10"

Inside: 31" x 16" x 10"

Bowl Size: 17" x 16" x 9"

13" x 16" x 9"

Minimum Cabinet Size 36"

Certification/Warranty

- ASME A 112.19.3
- CSA B45.4
- Limited Lifetime Warranty

Accessories Included



Strainer
Model: 202012

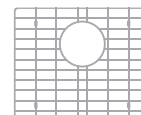

Grid
Model: G203321B
Model: G203321S

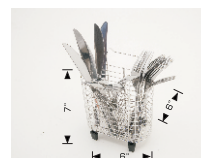

Plate Holder
Model: 202041



Basket
Model: 202040

Optional Accessories



Model: 202015B



Cutting Board
Model: 202020

Bosco Canada Inc. is known around the world for producing high quality kitchen sinks that incorporate modern design and functional superiority in every piece they manufacture.