

BOSCO Bathroom Series Undermount Sink Model No. 200040

For over 25 years, BOSCO Canada has been manufacturing and supplying sinks which are elegant, practical and functional. In addition to quality, BOSCO Canada prides itself on providing value for every sink they design and manufacture. Their timeless appeal, beveled edges and clean geometry makes them second to none.

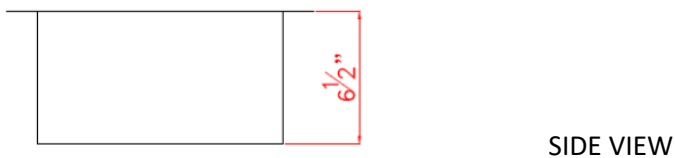
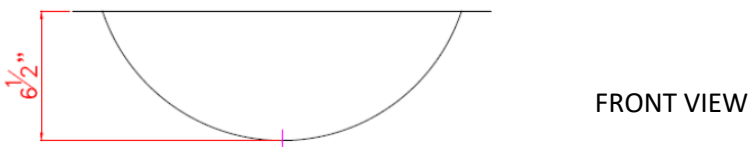
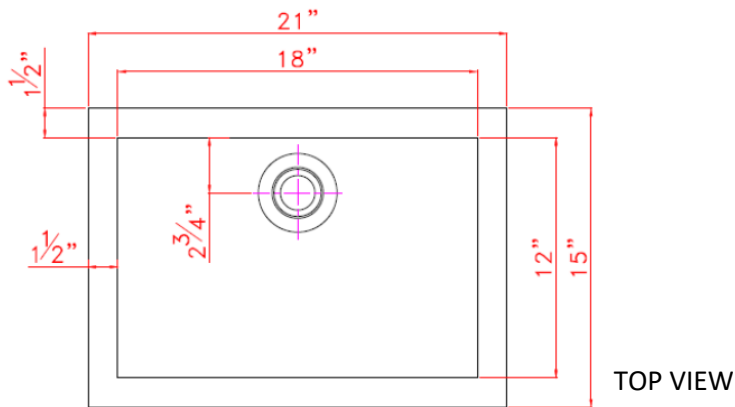

Specifications

- Outside Dim.: 21" x 15" x 6 1/2"
- Inside Dim.: 18" x 12"
- Bowl Depth: 6 1/2"
- Drain Opening: 2 3/4"
- 304 Stainless Steel
- Classic Rectangular Bowl
- 18 Gauge
- Off-set Strainer

Certification

- ASME A 112.19.3
- CSA B45.4
- Limited Lifetime Warranty

BOSCO Canada Inc. is known around the world for producing high quality ceramic and stainless steel sinks that incorporate modern design and functional superiority in every piece they manufacture.